

These instructions apply to all Godfrey Hirst laminate floors. Please refer to the product packaging or specification sheet for specific product locking system type.

Godfrey Hirst recommends installation be carried out by a professional flooring installer.

Warning

Prior to any take-up or removal of floorcoverings, adhesives, or underlay, you should be certain these do not contain asbestos. If it is known or suspected the previous flooring, adhesive, or underlay contains asbestos, you should avoid creating dust and the previous flooring and/or components should only be removed by an appropriately licensed asbestos removal contractor.

General

1. Inspect the product in good lighting conditions to ensure it is correct (colour, quality, and quantity) as ordered. Godfrey Hirst laminate flooring is for interior use only.
2. Always stack and transport boxes flat and never on their ends. Damage can occur to boards within boxes if not handled correctly.
3. Laminates require a floating floor installation. Ensure all permanent fixtures & fittings are installed prior to installation of flooring, allowing the required space for expansion. Any fixed items, including combustion wood heaters, furniture, or any other items 200kg or greater should not be placed on the floor.
4. Note locking systems on product packaging or specification sheet.
5. Ensure conditions of the product and site are in balance before, during, and after installation. The product must be acclimatised in the installation area for at least 24-48 hours in unopened packs at a temperature between 18-27°C and relative humidity between 35-75%. This temperature and humidity range is to be maintained before, during, and after installation. Packs should be stacked flat on the floor during acclimatisation and not be opened until the day of installation.
6. Subfloors shall be in accordance with AS1884:2021, meaning they must be solid, level, dry, and clean. In the absence of a 2000mm straight edge, a 1000mm can be used, however, irregularities must not exceed 2mm over 1000mm in this case.
7. The subfloor must be measured for moisture content according to the current Australian Standard 1884:2021 Appendix A or B. Where indicated subfloor moisture content exceeds the requirements of AS1884, a moisture vapour barrier must be installed.
8. Use a recognised 2mm moisture barrier underlay and completely tape all joins with moisture-resistant tape. Run underlay at least 50-100mm up all vertical surfaces and trim back after installation. (These are the single most important steps to a good installation and a great performing floor).
9. Minimum 10mm expansion gaps are to be provided at all fixed vertical surfaces (including around cabinetry, island benches, and all fixed furniture, including combustion wood heaters).
10. It is the responsibility of the installer to check to ensure the correct material (colour, pattern, and quantity) has been supplied from the same batch. The material is inspected for visual defects in a well-lit area before proceeding with installation. Should the material or batching be incorrect, or where defects are apparent the supplier must be contacted prior to installation. Complaints or claims raised regarding clearly identifiable visual defects will not be accepted after installation.
11. Clean any debris out of the locks before installation. Always use boards from several packs and inspect each board to get the best-balanced visual installation. Never install defective product. Installation is recognised as acceptance of all visual defects.
12. When cutting boards during installation, cut décor face up with a hand saw and/or cut décor face down with a power saw. If cutting boards using any type of saw, dust extraction and/or respiratory protection must be used.
13. Skirting boards or Godfrey Hirst scotia and/or end caps will be needed to cover the perimeter expansion gap. Skirtings are required to be fitted with space under them to allow the floor to expand and contract freely. Alternatively, the skirting boards can be undercut. Fixings should be to the wall only, never directly to the floor. Silicone or caulking compound must not be used. Godfrey Hirst has accessories to match/complement the laminate flooring.
14. The minimum width of boards for the first and last rows is 40mm. The end stagger of joins in rows should be a minimum of 300mm.
15. Ensure that the first 3-4 rows are checked for straightness using a string line. Continue to check for straightness at all stages of the installation.
16. Internal expansion breaks are to be provided at doorways, thresholds, and open areas exceeding 10mx10m.

17. Godfrey Hirst Laminate flooring can be installed in individual rooms up to 10m long and 10m wide. In complex or multi-room installations, internal expansion joints at doorways/thresholds are required. This allows for individual rooms to expand and contract freely. A complex installation occurs anywhere a common room or area, such as a lounge or hallway, leads to another room through a doorway or narrow opening that could create a 'pinch point' that would restrict the movement of the raft.
18. Never install fixings through the flooring, such as floor-mounted door stoppers, sliding door runners, wardrobe tracks, bi-fold door rails, etc. These will pin the flooring in place, preventing expansion and leading to floor failure.

Please note:

1. Godfrey Hirst recommends that batches not be mixed. In circumstances where the installer has two or more batches, they must check to ensure they are compatible in design, colour, surface texture, gloss level, dimensions, and locking system.
2. Many problems with floating floors relate to excessive moisture. Ensure the subfloor is dry (75% or less in-slab relative humidity) and the moisture barrier and underlay are correctly installed and completely taped.
3. Although some Godfrey Hirst Laminate flooring is moisture resistant it does not substitute for a waterproof barrier. It should not be installed in areas that have a continual risk of excessive moisture/flooding such as saunas or outdoor areas.
4. Laminate floors must be installed using a floating floor system – they need to be able to move. Ensure expansion gaps allow for movement, and furniture items exceeding 200kg are not placed on the floor. Do not nail or screw the product to the subfloor, this includes door stops.
5. Insufficient expansion gaps, including in doorways and under trims, may cause buckling, peaking, cupping and/or separation of the flooring, which in most cases will lead to failure of the installation.
6. Godfrey Hirst laminate flooring should never be installed over any electrical radiant heating system - the speed of sudden temperature changes has the potential to negatively affect the floor. Godfrey Hirst laminate flooring may, if properly installed, be installed over hydronic underfloor radiant heating systems.
7. Uneven subfloors can cause the locking system to break and/or the floor to sound drummy, or become noisy, and will cause early deterioration and/or failure of the floor.
8. Godfrey Hirst Laminate floors are not recommended for hairdressing salons or other commercial/retail environment where display shelving, racking, or loads are constantly positioned in place.
9. Care and Maintenance Guidelines must be followed to maintain the product warranty. Please ensure the occupier refers to the Godfrey Hirst Laminate Care and Maintenance Guidelines found at www.godfreyhirst.com/au/news/hard-flooring-care-guides.

Detailed Drawings

1. Perform preparation works including (but not limited to) any leveling, and undercutting of door jambs and/or skirting boards and correctly install the underlay and fully tape the joints.
2. Laminate floors are normally installed adjacent to the longest run where possible. Plan your installation, refer to note 7, which may necessitate trimming the first row.
3. Start in the left corner, and install the first row. Leave a minimum expansion gap of 10mm at the ends and sides.

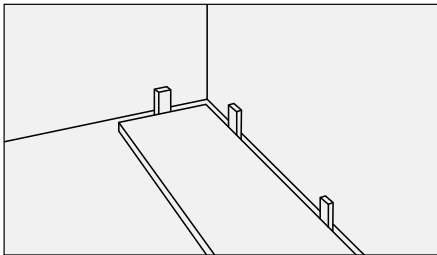

4. **Install the second row:**
Use the offcut from the first row to start the second row. It must be $>300\text{mm}$, and not closer than 300mm from the end join in the previous row.

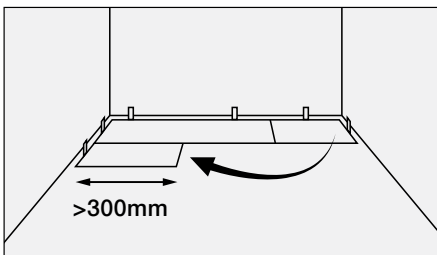

Locking System Fold Down:

Long side first, then fold down.

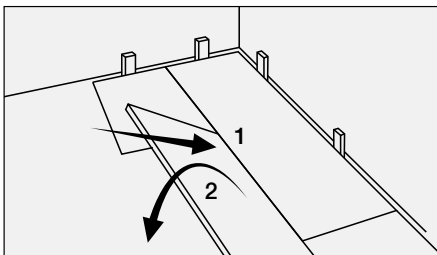

Locking System Angle-Angle:

Short side first, then slightly lift the row and engage the long side. Or the long side first and side tap the short side with a tapping block.

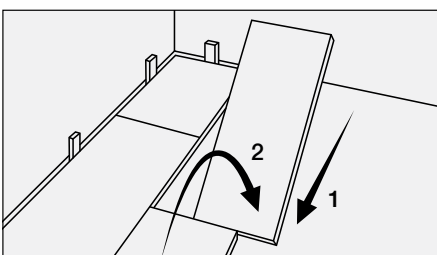

Always tap the long join with a tapping block to ensure complete engagement. Never strike the floor directly as this will damage the locking system – always use a block.

5. Continue laying the floor. Place wedges/packers to ensure the minimum 10mm expansion gap is respected. Always tap the long join with a tapping block.
6. At doorways, trim the male part of the end click on Fold Down products so the board can slide under the architrave. Use a non-foaming polyurethane adhesive for the trimmed joint, engage the long side of the board, and use a tapping block to engage the short end of the board. Unilin Unifit™ products can be side-tapped.

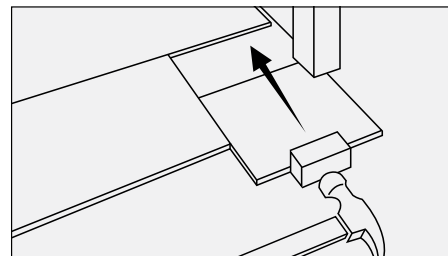

7. The final row must be a minimum of 40mm in width. Glue the last rows end joins with non-foaming polyurethane adhesive if not able to side-tap.

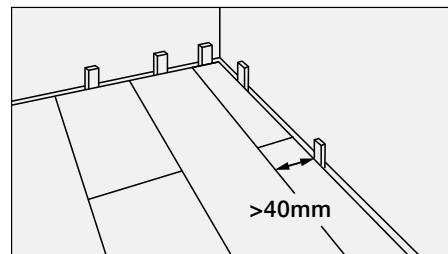

8. Internal expansion breaks are required at doorways/thresholds and rooms exceeding 10mx10m.
9. Remove spacers/wedges from around the room and install skirting boards and/or Godfrey Hirst scotia and/or finishing trims (in accordance with Godfrey Hirst accessories installation guidelines). Never fix any trims directly to the floor and ensure fixing does not compromise expansion gaps. Silicone or caulking compound must not be used.